



QUALITY • COMPETENCE • COMPLIANCE

1300 008 274
Traffic@varigroup.com.au

Client:	Buildcorp
Road Name:	Pitt St
Suburb:	Sydney
Road Type:	2 Lane 1 Way
Operation:	Tower Crane Install
Term:	Short
Speed Limit:	40km/h
Speed Reduction:	N/A
ROL Number:	TBC
ROL Classification:	TBC
Date Prepared:	04/05/23
Date Approved:	04/05/23
Date Revised:	11/05/23
TC@WS REFERENCE BASED ON TCP #92	PWZTMP
N.C.S.:	Hunter St
Designed By:	Noah Nguyen-Luu #1025516
Approved By:	Daneil Marzetti #0052242601
Size:	A1
Plan Reference Number:	00BCAP14
TCs Required:	7

RECOMMENDED TAPER LENGTH

Traffic Speed (Km/H)	Traffic Control at beginning of Taper	Later shift taper	Merge Taper
45 or less	15	0	15
45 - 55	15	15	30
56 - 65	30	30	60
66 - 75	N/A	70	115
76 - 85	N/A	80	130
86 - 95	N/A	90	145
96 - 105	N/A	100	160
> 105	N/A	110	180

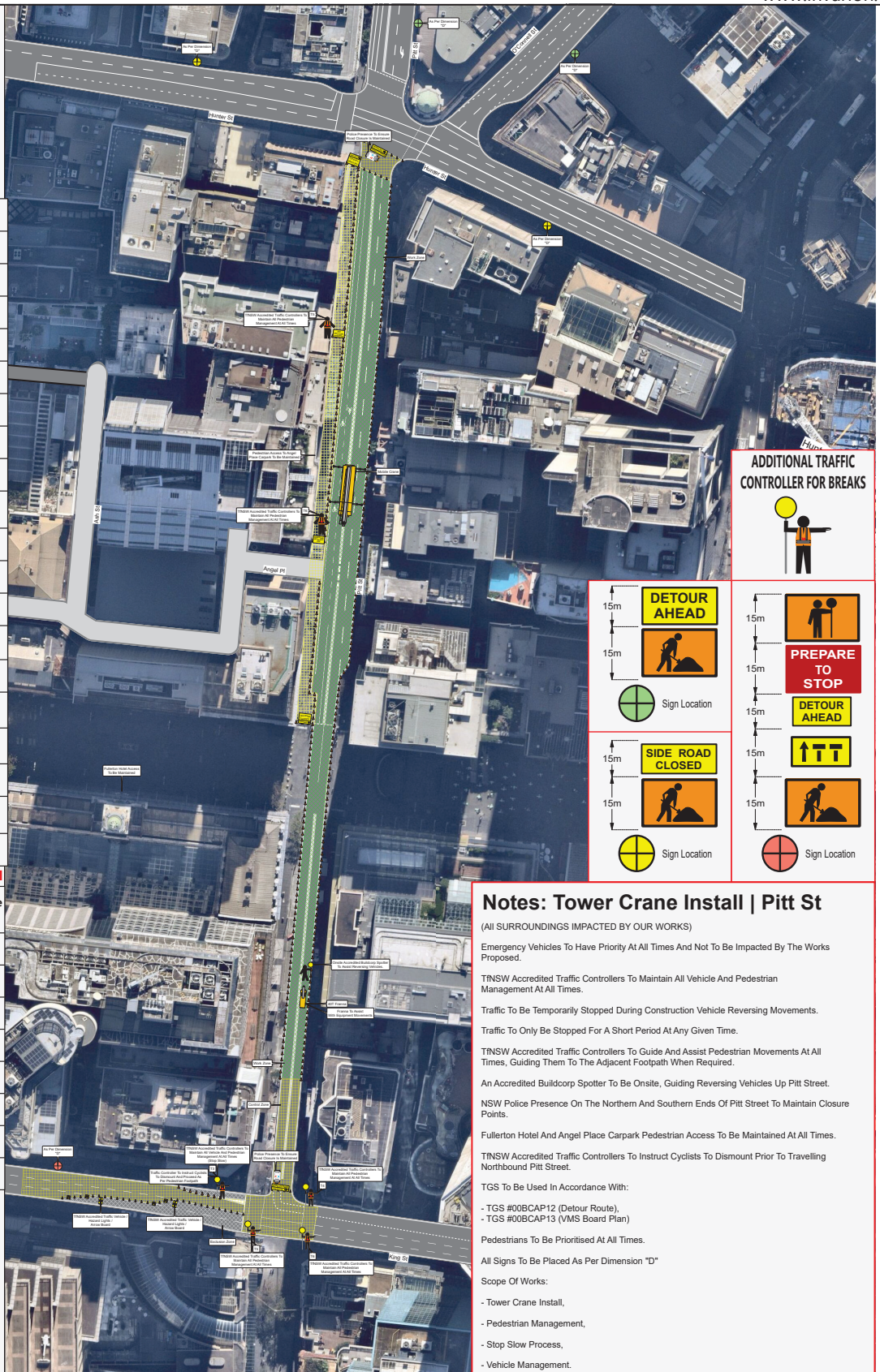

ADDITIONAL TRAFFIC CONTROLLER FOR BREAKS



15m	DETOUR AHEAD	15m	
15m		15m	PREPARE TO STOP
15m	Sign Location	15m	DETOUR AHEAD
15m	SIDE ROAD CLOSED	15m	
15m		15m	
15m	Sign Location	15m	Sign Location

Notes: Tower Crane Install | Pitt St

(ALL SURROUNDINGS IMPACTED BY OUR WORKS)

Emergency Vehicles To Have Priority At All Times And Not To Be Impacted By The Works Proposed.

TNSW Accredited Traffic Controllers To Maintain All Vehicle And Pedestrian Management At All Times.

Traffic To Be Temporarily Stopped During Construction Vehicle Reversing Movements.

Traffic To Only Be Stopped For A Short Period At Any Given Time.

TNSW Accredited Traffic Controllers To Guide And Assist Pedestrian Movements At All Times, Guiding Them To The Adjacent Footpath When Required.

An Accredited Buildcorp Spotter To Be Onsite, Guiding Reversing Vehicles Up Pitt Street.

NSW Police Presence On The Northern And Southern Ends Of Pitt Street To Maintain Closure Points.

Fullerton Hotel And Angel Place Carpark Pedestrian Access To Be Maintained At All Times.

TNSW Accredited Traffic Controllers To Instruct Cyclists To Dismount Prior To Travelling Northbound Pitt Street.

TGS To Be Used In Accordance With:

- TGS #00BCAP12 (Detour Route),
- TGS #00BCAP13 (VMS Board Plan)

Pedestrians To Be Prioritised At All Times.

All Signs To Be Placed As Per Dimension "D"

Scope Of Works:

- Tower Crane Install,
- Pedestrian Management,
- Stop Slow Process,
- Vehicle Management.

Dimension "D"

SPEED OF TRAFFIC (KM/H)	AS.1742.3	TC@WS
45 OR LESS	15m	15m
46 - 55	15m	50m
56 - 65	45m	60m
GREATER THAN 65	EQUAL TO POSTED SPEED LIMIT	

GENERAL NOTES

1. THE AS1742.3 & TC@WS 2010 WITH TC@WS 2010 TO BE READ CONJUNCTION WITH THE TC@WS 2010.
2. ALL TRAFFIC CONTROL DIAGRAMS TO BE READ CONJUNCTION WITH THE TC@WS 2010.
3. NON APPLICABLE EXISTING SIGNAGE SHALL BE COVERED E.G. SPEEDS SIGNS DUE TO THE TEMPORARY SPEED ZONE.
4. ALL SIGNAGE DISTANCE SHALL COMPLY WITH AS 1742.3 & TC@WS 2010.
5. IN ACCORDANCE WITH TC@WS 2010 TRAFFIC CONTROLLERS TO ASSIST PEDESTRIANS WITH MOVEMENT THROUGH & AROUND THE WORKSITE.
6. SIGNAGE SHALL BE PLACED ON THE SIDE OF THE ROAD ADJACENT TO THE TRAFFIC FLOW.
7. REMOVAL OF TRAFFIC CONTROL SIGNS AND DEVICES SHOULD BE UNDERTAKEN IN THE REVERSE ORDER OF ERECTION, PROGRESSING FROM THE WORK AREA OUT TOWARD THE APPROACHES.

QUEUE MANAGEMENT

AT ALL TIMES DURING THE COURSE OF THE WORK, TRAFFIC QUEUES SHALL BE MONITORED TO ENSURE THAT TRAFFIC DOES NOT EXCEED BEYOND THE LIMITS OF ADVANCED WARNING SIGNS.

TOLERANCES

POSITIONING OF SIGNS MINIMUM 10% LESS THAN THE DISTANCE OR LENGTHS GIVEN MAXIMUM 25% MORE THAN THE DISTANCE OR LENGTHS GIVEN SPACING OF DELINEATING DEVICES MAXIMUM 10% MORE THAN THE SPACING GIVEN NO MINIMUM.

VEHICLE MOVEMENT PLAN

ALL WORK VEHICLES TO ENTER AND EXIT WORKSITE UNDER THE DIRECTION OF TRAFFIC CONTROLLERS WITH THE TRAFFIC FLOW ON DESIGNATED UHF CHANNEL.

TGS IMPLEMENTATION

VARI GROUP DOES NOT ACCEPT LIABILITY FOR OR ENDORSE THE USE OF THE TGS UNLESS IMPLEMENTED DIRECTLY BY AN AUTHORIZED REPRESENTATIVE OF VARI GROUP, HOLDING VALID QUALIFICATIONS TO CARRY OUT SUCH WORKS.

LANE WIDTHS

THE MIN LANE WIDTH TO BE PROVIDED THROUGH OR PAST THE WORKSITE FOR VEHICLES SHALL BE 3.0m (3.5m DESIRABLE).

Emergency Vehicles To Have Priority At All Times And Not To Be Impacted By The Works Proposed.